



SYMONDS + GREENHAM

Estate and Letting Agents



23 Ulverston Road, Hull, HU4 7HL

Offers over £170,000

Nestled in the charming area of Ulverston Road, Hull, this delightful terraced house presents an excellent opportunity for a starter family home. Boasting three well-proportioned bedrooms and a loft room, this property is perfect for those looking to establish roots in a friendly and welcoming community.

Upon entering, you will find a spacious reception room that offers a warm and inviting atmosphere, ideal for family gatherings or quiet evenings in. The heart of the home is undoubtedly the beautiful open plan kitchen diner, which is designed to be both functional and stylish. This space is perfect for family meals and entertaining guests, with ample room for dining and cooking.

One of the standout features of this property is the south-facing garden, which allows for plenty of natural light to flood in, creating a bright and cheerful environment. This outdoor space is perfect for children to play, or for adults to relax and enjoy the sunshine.

The location is particularly advantageous, being in close proximity to Hessle Square, where you will find a variety of amenities to cater to your everyday needs. From shops to cafes, everything you require is just a short stroll away. The area is known for its good community spirit and friendly neighbours, making it an ideal place for families to thrive.

In summary, this terraced house on Ulverston Road is a wonderful opportunity for those seeking a comfortable and inviting home in a popular location. With its beautiful kitchen diner, three bedrooms, and a lovely garden, it is sure to appeal to families looking to settle down in Hull.

LOUNGE

11'0 x 15'10 max (3.35m x 4.83m max)

Bay window

KITCHEN DINER

14'6 x 17'5 max (4.42m x 5.31m max)

Base to eye level units, sink and draining unit, integrated fridge freezer, integrated electric oven and microwave, gas hob, integrated dishwasher, integrated washing machine, breakfast bar, French doors leading to the garden

BEDROOM ONE

9'4 x 14'0 max (2.84m x 4.27m max)

Bay window

BEDROOM TWO

9'4 x 11'8 max (2.84m x 3.56m max)

BEDROOM THREE

6'0 x 7'6 max (1.83m x 2.29m max)

Stairs leading to loft room

BATHROOM

5'9 x 6'5 max (1.75m x 1.96m max)

Panelled bath with over head shower, trough-style sink, low level w/c

LOFT ROOM

12'6 x 12'9 max (3.81m x 3.89m max)

Velux window

OUTSIDE

Drive to the front of the property. Rear garden with astral turf lawn and patio path and garage

CENTRAL HEATING

The property has the benefit of gas central heating (not tested).

COUNCIL TAX BAND

Symonds + Greenham have been informed that this property is in Council Tax Band "B"

DOUBLE GLAZING

The property has the benefit of double glazing.

TENURE

Symonds + Greenham have been informed that this property is Freehold

DISCLAIMER

Symonds + Greenham do their utmost to ensure all the details advertised are correct however any viewer or potential buyer are advised to conduct their own survey prior to making an offer.

VIEWINGS

Please contact Symonds + Greenham on 01482 444200 to arrange a viewing on this property.

GROUND FLOOR
474 sq.ft. (44.0 sq.m.) approx.

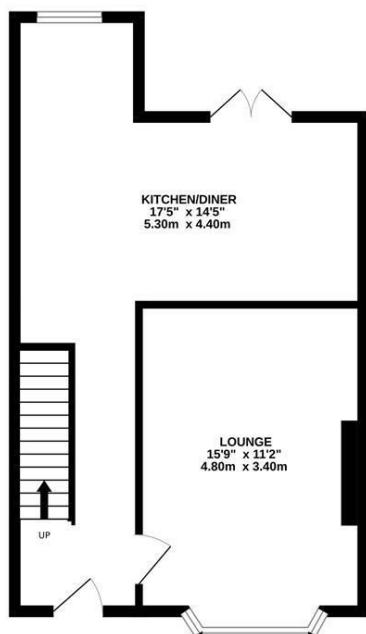

1ST FLOOR
447 sq.ft. (41.5 sq.m.) approx.

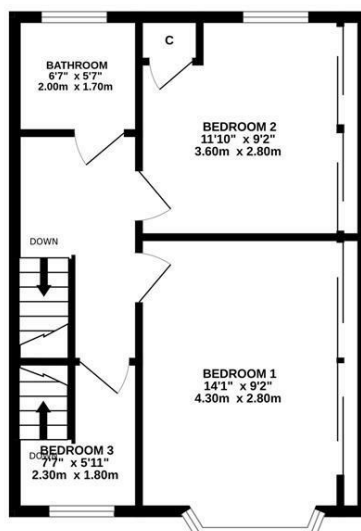

2ND FLOOR
195 sq.ft. (18.1 sq.m.) approx.

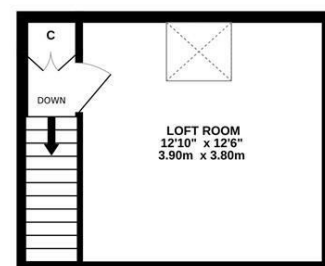

TOTAL FLOOR AREA : 1116 sq.ft. (103.6 sq.m.) approx.

Whilst every attempt has been made to ensure the accuracy of the floorplan contained here, measurements of doors, windows, rooms and any other items are approximate and no responsibility is taken for any error, omission or mis-statement. This plan is for illustrative purposes only and should be used as such by any prospective purchaser. The services, systems and appliances shown have not been tested and no guarantee as to their operability or efficiency can be given.
Made with Metropix ©2025

Energy Efficiency Rating		Current	Potential
Very energy efficient - lower running costs			
<div><div></div><div>(92 plus) A</div></div>			<div><div></div><div>83</div></div>
<div><div></div><div>(81-91) B</div></div>			
<div><div></div><div>(69-80) C</div></div>			
<div><div></div><div>(55-68) D</div></div>			
<div><div></div><div>(39-54) E</div></div>			
<div><div></div><div>(21-38) F</div></div>		<div><div></div><div>59</div></div>	
<div><div></div><div>(1-20) G</div></div>			
Not energy efficient - higher running costs			
England & Wales		EU Directive 2002/91/EC	

Environmental Impact (CO ₂) Rating		Current	Potential
Very environmentally friendly - lower CO ₂ emissions			
(92 plus) A			
(81-91) B			
(69-80) C			
(55-68) D			
(39-54) E			
(21-38) F			
(1-20) G			
Not environmentally friendly - higher CO ₂ emissions			
England & Wales		EU Directive 2002/91/EC	